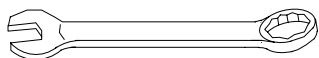




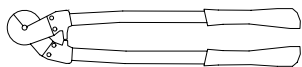
**English**

**ASSEMBLY INSTRUCTIONS**





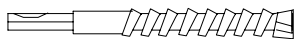
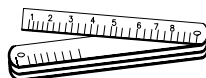
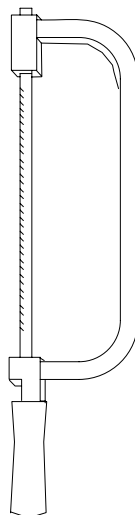
10 13 19 mm



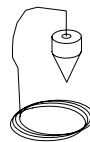
Ø 4



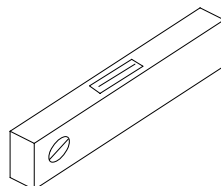
1,5 2 2,5 3 4 5 6 mm



Ø 8x120    Ø 14x150 mm



Ø 6,5 mm



## English

Before starting the assembly, unpack all the pieces of the staircase. Spread them out on a spacious surface and check the number of pieces (TAB. 1; (A = Code, B = Quantity)).

Inside the staircase box you will also find a DVD which we suggest watching before proceeding to assemble.

For customers in the USA there is a customer assistance number 1-888 STAIRKT, which you can telephone in case of problems.

### Assembly

- Carefully measure the height from floor to floor.
- Calculate the value of the riser:
  - subtract 22 cm (8 5/8") from the value you obtained for the height from floor to floor,
  - divide this value by the number of risers, less one.Example: for a height measured from floor to floor of 268 cm and a staircase with 12 risers;  
 $(268 - 22) / (12 - 1) = 22,36$  (8'3 1/2" - 8 5/8") / (12 - 1) = 8 3/4".
- Determine the position in which to fix the N19 support (fig. 1) considering two points:
  - the riser, as previously calculated, also includes the thickness of the step (L19 or L20) (fig.2).
  - position the N19 support considering the type of hole (fig. 3).
- Drill the holes with a Ø 14 bit.
- Assemble on the floor the N19, N18, N17 and N16 supports in a rectilinear configuration, considering the riser previously calculated. Use components C15, B71 and B75 (fig. 1). Tighten sufficiently, bearing in mind that the N19, N18, N17 and N16 supports must still be turned for the B configuration.
- Raise and position the structure with the N19 support in contact with the ceiling aperture (fig. 4). Should the stair-well be tight, you are advised to turn some of the supports.
- Permanently fix the N19 support, using component C39 (fig. 1).
- Arrange on the floor, in succession, one left step (L19), one right step (L20) and so on. Determine at this point which is the first step from the top.
- Decide where to assemble the banister (inside or outside) and drill holes in the steps (L19, L20) with a Ø 6,5 bit, in accordance with the measurements in the drawings for each configuration (fig. 3).
- Assemble and fix the F29 components using components C14, B83, B86, C13 and B02 (fig. 1).
- Permanently fix the steps (L19, L20), starting from the top and working downwards to support N16, using components C57/C40 (fig. 1).
1. Configuration A (rectilinear) does not require any further modifications (fig. 3).
  - Configuration B needs a 5 ° rotation (fig. 3).
- To rotate the supports by 5° proceed as follows:
  - Trace with a pencil, at the point where the two supports meet, two vertical lines at a distance of 3,5 mm (fig. 5).
  - Loosen the C15 components, one support at a time, starting from the top and rotating them until one line meets the other.
  - Permanently tighten the C15 components (fig. 1).

### Assembly of the banister

- Cut the balusters as shown in the diagrams. The balusters positioned on the edges, for which the diagrams do not show measurements for making the cuts, must be cut according to the inclination of the staircase banister and therefore not until the handrail A13 has been mounted.
- Assemble components C69, C77, D43, C79 and C65 to the balusters C67 (fig. 1), (fig. 6)
- Insert the balusters (C67) into components F29, orientating component C79 so that the holed part faces upwards and locking them with component B02. Check that each baluster is vertical. Starting from the highest baluster, fix the handrail A13 with items C64 and a screw-driver (leave un-inserted at the end a quantity of handrail sufficient to fix baluster C67 to). Join the components of the handrail A13 with items B33. Determine the height of the balusters at the ends of the banister, cut them and insert them into components F29 locking them with item B02.

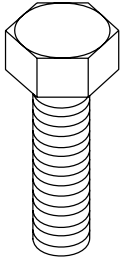
- In correspondence with the first and last balusters, cut off the excess handrail and complete the assembly by inserting component A12 using item C64 and the glue X01 (fig. 1).
17. Insert the steel cables in the items C69 present on the balusters. Lock the cables onto one of the two ends with items D37 and C76, leaving 5mm of the cable protruding from item D37. Tighten the cables by hand and lock them with items D37 and C76. Cut off the cable at a distance of 5 mm from item D37. Screw on components D36, which protect users from the cables. Warning: to cut the cables, we suggest that you use suitable shears, and that you wrap adhesive tape around the part of the cable to be cut so that it will not unravel.

### **Final Assembly**

18. Verify that the whole staircase is vertical, and if necessary adjust it by moving support N16 (fig. 1).
19. Detach the first step (L19 or L20) and, using a Ø 14 bit, drill holes in the floor in line with the holes in support N16 (fig. 1).
20. Insert components C39 and permanently tighten them (fig. 1).
21. Replace the first step (L19 or L20) and, drilling the holes with an Ø 8 bit, fix component F34 to the floor so that it corresponds with the first baluster (only when the banister is in place on the left side as you go up). Use components B11, B12 and B02. Insert baluster (C67) and tighten component B02 (fig. 1).
22. Complete the staircase assembly by inserting items C74 into the balusters C67 (fig. 1).

**TAB 1**

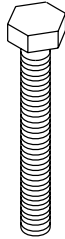
A	B
A12	2
A13	3
B02	16
B11	1
B12	1
B33	2
B71	20
B75	40
B83	28
B86	14
C13	14
C14	14
C15	20
C39	4
C40/C57	44
C54	6
C64	14
C67	6
C69	42
C74	6
C76	14
C77	42
C79	6
D36	14
D37	14
D43	6
F26	1
F29	14
F34	1
L19	6
L20	5
N16	1
N17	1
N18	8
N19	1



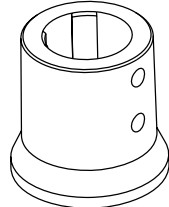
C15



B75



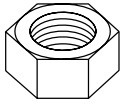
C14



F34



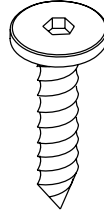
B02



B71



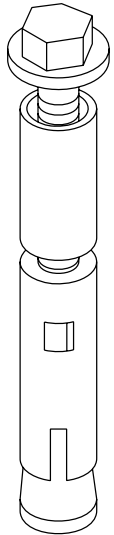
B86



C40/C57



C64



C39



C13



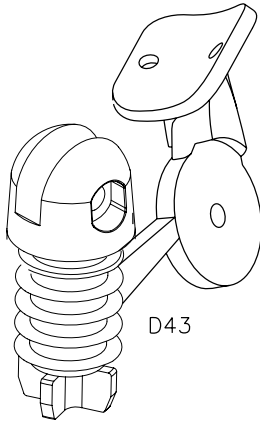
C79



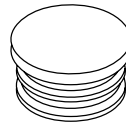
C65



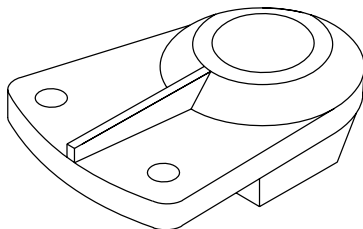
B83



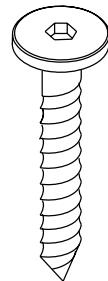
D43



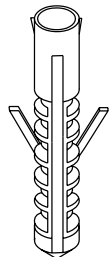
C74



F29

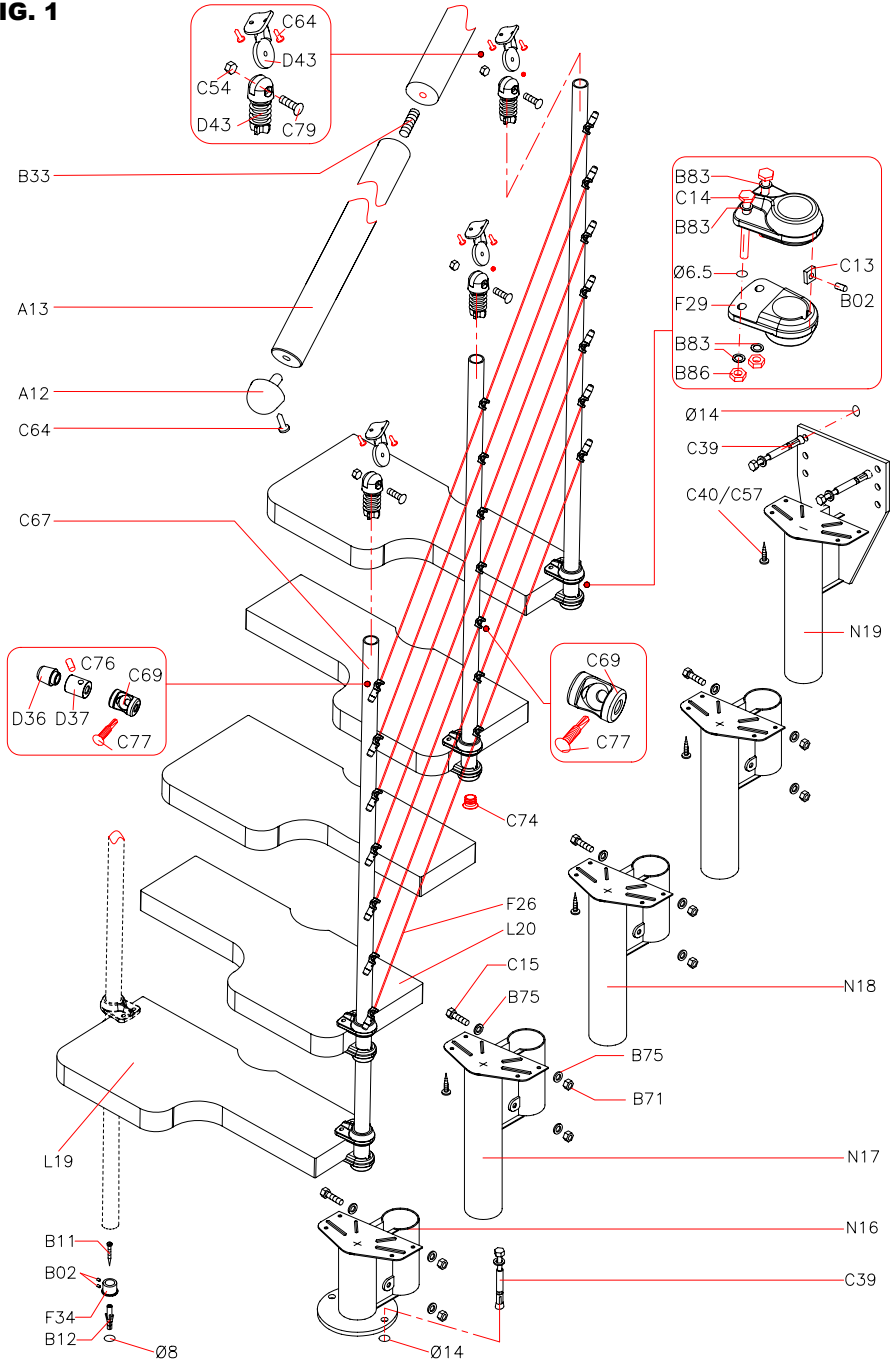


B11

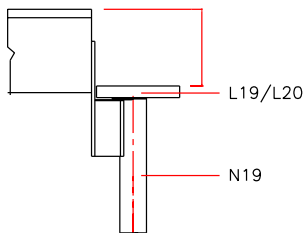


B12

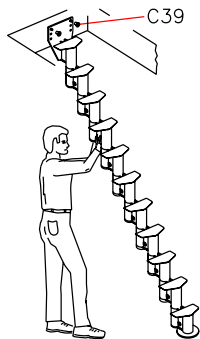
**FIG. 1**



**FIG. 2**

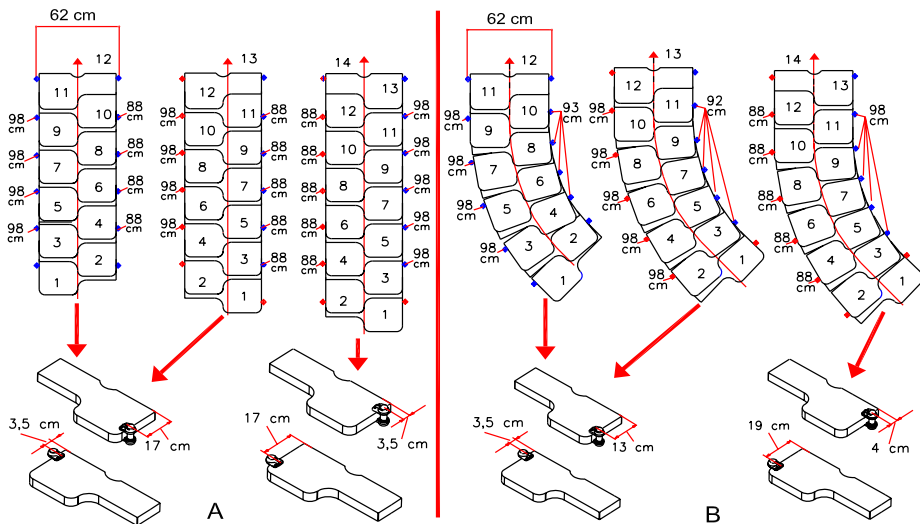


**FIG. 4**

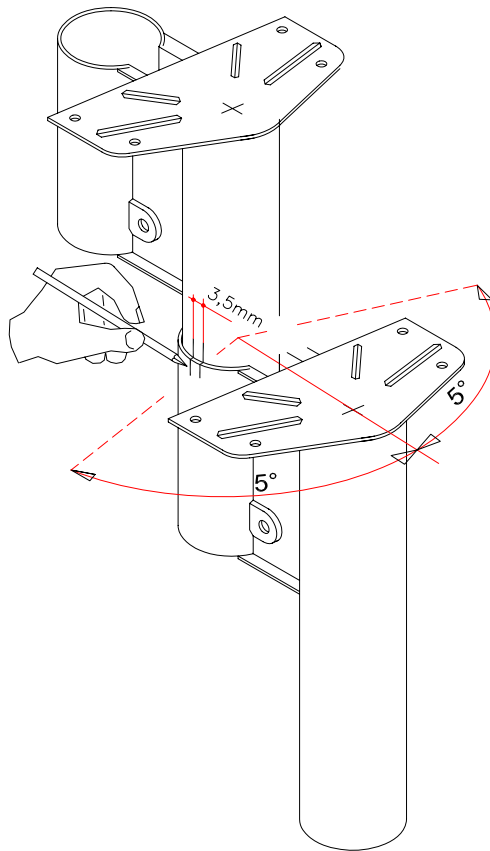


**FIG. 3**

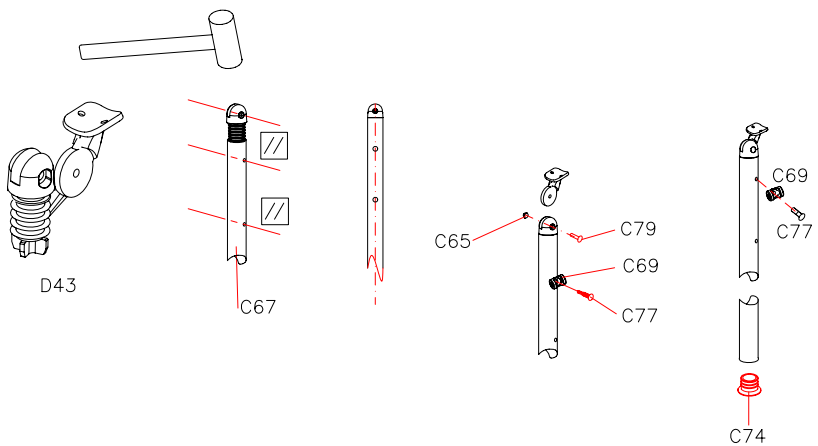
HÖHE HEIGHT ALTURA HAUTEUR ALTEZZA HOOGTE WYSOKOŚĆ ALTURA VISINA VÝŠINA VÝŠKA HÖUDE HÖJD KORKEUS	ANZAHL STUFEN/HÖHEN NUMBER OF RISERS NUMERO TABLIAS NOMBRE HAUTEURS NUMERO ALZATE AANTAL OPTREDENS ILOŚĆ WYSOKOŚCI NUMERO DE ALTURAS BROJ VISINA ŠTEVILO VIŠIN POČET VÝSEK SCHODŮ ANTAL STIGNINGER NUMMER STEG NOUSIJEN MÄÄRÄ	ANZAHL STUFEN NUMBER OF TREADS NUMERO PELDANOS NOMBRE MARCHES NUMERO GRADINI AANTAL TREDEN ILOŚĆ STOPNI NUMERO DE DEGRAUS BROJ GAZIŠTA ŠTEVILO STOPNIC POČET SCHODNIC ANTAL TRIN NUMMER TRAPPSTEG ASKELMIEN MÄÄRÄ	STUFENHOHE MEASURE OF RISERS TABLIAS VALEUR DES HAUTEURS VALORE ALZATA HOOGTE OPTREDEN WYSOKOŚĆ VALOR ALTURA VISINA GAZIŠTA VÝŠINA STOPNE PLOŠČE HODNOTA VÝŠKY SCHODŮ STIGNINGSVÆDIER STEG NOUSUN KORKEUS	ERSTE STUFE OBEN 1st TREAD ON TOP PRIMERO PELDANO EN ALTO 1er MARCHÉ EN HAUT GRADINO DI PARTENZA DALL'ALTO ERSTE TREED BOVEN PIERWSZY STOPNIEN OD GÓRI 1° DEGRAU EM CIMA GORNJE POLAZNO GAZIŠTE ZGORNJA STOPNA PLOŠČA POČATEČNÍ SCHODNICE NAHORE STARTTRIN FRA ÖVEN FÖRSTA TRAPPSTEGET UPPIFRÄN ALKUASKELMA YLHÄÄLTÄ LÄHTIEN	ERTSE STUFE UNTEN 1st TREAD ON BOTTOM PRIMERO PELDANO ABAJO 1er MARCHÉ EN BAS GRADINO DI PARTENZA DAL BASSO ERSTE TREED VAN BENEDEN PIERWSZY STOPNIEN OD DOLU 1° DEGRAU EM BAKO DONJE POLAZNO GAZIŠTE SPODNIA STOPNA PLOŠČA POČATEČNÍ SCHODNICE DOLE STARTTRIN FRA NEDEN FÖRSTA TRAPPSTEGET NERIFRÄN ALKUASKELMA ALHÄÄLTÄ LÄHTIEN
H cm			cm		
209+258.5	11	10	19 + 23.5		
228+282	12	11	19 + 23.5		
247+305.5	13	12	19 + 23.5		
266+329	14	13	19 + 23.5		

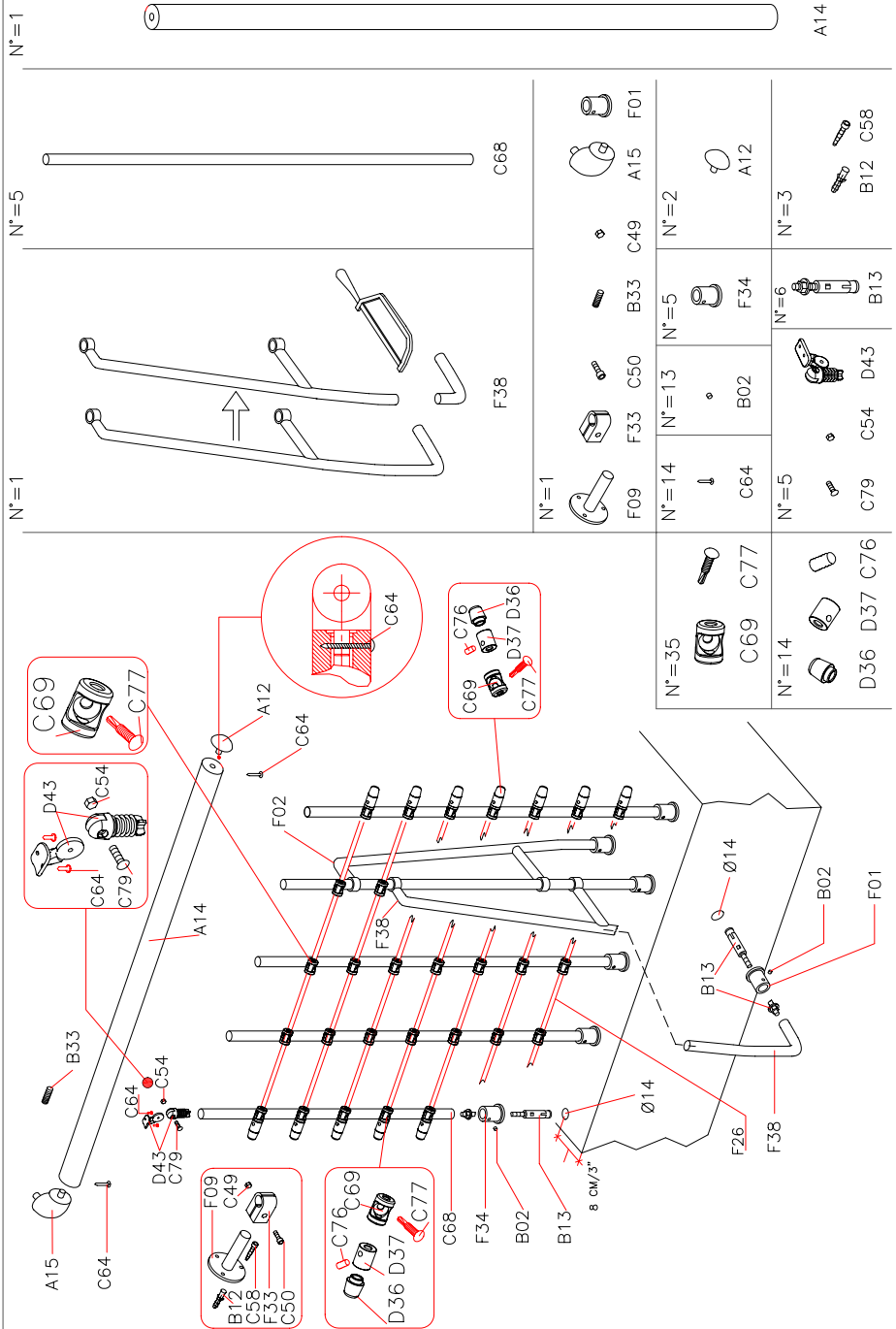


**FIG. 5**



**FIG. 6**







**Albini & Fontanot S.p.A.**

ITALY - 47853 Cerasolo Ausa (Rimini) - Via P.P. Pasolini, 6

Tel. +39 0541 906111 Fax +39 0541 906125

[www.arke.ws](http://www.arke.ws)

D.U.M 01/2008